



香港教育大學  
The Education University  
of Hong Kong



# 幼教研討會2021

Conference for Research in  
Early Childhood Education 2021

主題：新常態下的幼兒健康與福祉

THEME: Early Childhood Education:  
Health and Well-being in the New Normal

20 December 2021  
二零二一年十二月二十日



Faculty of Education  
and Human Development  
教育及人類發展學院



Department of  
Early Childhood Education  
幼兒教育學系

# 目錄 Content

歡迎辭 <b>Welcome Messages</b>	<b>4</b>
研討會主辦單位 <b>Conference Organizer</b>	<b>6</b>
研討會程序概覽 <b>Conference Programme Overview</b>	<b>7</b>
專題演講 <b>Plenary Sessions</b>	<b>8</b>
分組研討 <b>Parallel Sessions</b>	<b>16</b>
鳴謝：伙伴學校 <b>Vote of Thanks: School Partners</b>	<b>35</b>
附錄——教大地圖 <b>Appendix – EdUHK Map</b>	<b>50</b>

© The Education University of Hong Kong 2021

3

## Message from the Dean

I extend my most sincere welcome to all attendees of the Conference for Research in Early Childhood Education (CRECE) 2021 hosted by the Department of Early Childhood Education.

The theme of the conference this year is Early Childhood Education: Health and Well-being in the New Normal, which echoes the pandemic situation in Hong Kong. The conference provides an interactive platform for kindergarten educators, academics, professional workers, and schools to share their achievements and exchange their experience in teaching and student learning; and strategies for adapting the new normal to the school practices, children's learning experiences, and staff and school development. In addition to the keynote speech and seminars in the morning, the conference organizing committee has coordinated a series of seminars, workshops and chatrooms related to the theme in the afternoon. The aim of these activities is to facilitate discussion about early learning and allow you to experience excellence examples of application-in-action. Please take advantage of this opportunity to share and learn.

Over the last few years the CRECE has evolved into a unique event. Practitioners and educators gathered in this integrated event to showcase and share their ideas which makes the event so integrated and engaging. Although we may not be able to meet all of you in the same venue, the event still brings our spirits together. With all of your support, we provide a safe and welcoming environment for everyone to contribute on an equal footing – I am sure you will enjoy it and find it informative and professionally worthwhile. My thanks go to the keynote and invited speakers, and presenters who have helped to make this year's conference a success.



麥博思教授  
Professor Bruce Macfarlane

教育及人類發展學院院長  
Dean, Faculty of Education and Human Development



Faculty of Education  
and Human Development

教育及人類發展學院

## 系主任歡迎辭

歡迎各位教育及專業工作者參與第七屆幼教研討會。幼教研討會一直以來為參與者提供一個交流平台，讓幼兒教育工作者能聚首一堂，互相交流分享專業心得。

今年研討會以「新常態下的幼兒健康與福祉」為主題，為疫情下的教育工作者、家長及幼兒分享有關研究的成果。回顧過去兩年，疫情為香港帶來不少改變，除了改變我們的生活習慣，幼兒教育的教學模式也因時制宜。幼兒教育學系在這段時間展開了各方面的研究，目的為探討疫情下幼兒在成長道路上遇到的挑戰。誠如不同研究結果所說，我們作為教育工作者，甚至是家長，都應該為幼兒的身心健康與幸福多花心思，讓幼兒能夠在變幻莫測的新常態下也能愉快學習及成長。

鑒於疫情影響，本屆研討會將以實體及網上形式進行，雖然各同工未必能親臨現場，但我們仍然秉承過去的模式，為大家帶來不同體驗：除了有海外學者作專題演講外，幼兒教育學系的教職員也會就不同主題進行演說，帶給大家國際及本地資訊。此外，為使參與者之間能分享大家的實戰經驗及心得，我們也一如既往安排不同形式的專題發表，提供參與者一個難得的零距離交流平台，彼此學習，甚具裨益。

我期待各位在今天的研討會上皆能樂在其中，滿載而歸，也再一次感謝各位的參與及支持。我們會繼續與業界緊密合作，砥礪前行，為孩子的健康與福祉一起努力。



李敬廉教授  
Professor Kerry Lee

幼兒教育學系系主任  
Head, Department of Early Childhood Education



Department of  
Early Childhood Education

幼兒教育學系

## 研討會主辦單位 Conference Organizer

### 幼兒教育學系研究及高級學位委員會

#### Departmental Research and Higher Degrees Committee

---

主席 Co-chairs 張婉文博士 Dr. CHEUNG Yuen Man Rebecca  
蕭狄詩博士 Dr. SIU Tik Sze Carrey

---

委員 Members Dr. CAPIO Catherine Mamaid  
陳勁聰博士 Dr. CHAN King Chung Derwin  
李宜遜博士 Dr. LI Yixun Annie  
Prof. SALTMARSH Sue Okerson  
譚寶芝博士 Dr. TAM Po Chi Pansy

---

### 研討會籌辦委員會

#### Sub-committee for Departmental Conference

---

主席 Co-chairs 張婉文博士 Dr. CHEUNG Yuen Man Rebecca  
蕭狄詩博士 Dr. SIU Tik Sze Carrey

---

委員 Members Dr. CAPIO Catherine Mamaid  
陳勁聰博士 Dr. CHAN King Chung Derwin  
張森炯博士 Dr. CHEUNG Sum Kwing Sam  
李宜遜博士 Dr. LI Yixun Annie  
吳美莉博士 Dr. NG Mei Lee  
Prof. SALTMARSH Sue Okerson  
譚寶芝博士 Dr. TAM Po Chi Pansy

---

### 研討會秘書處

#### Conference Secretariat

---

鄭淦之女士 Ms. CHENG Kam Chi Gigi  
劉旭汶先生 Mr. LAU Yuk Man Andy

---

# 程序概覽 Programme Overview

上午 AM 地點 Venue C-LP-11 and Zoom

9:00-9:30 登記 Registration

9:30-9:45 開幕禮 Opening Ceremony

9:45-10:45 專題主講 Keynote Speech

在幼兒教育中推廣體育和運動技能的有效實證

What does the evidence say works in terms of promoting physical activity and movement skills in early childhood education?

E

Prof. Anthony Okely

Senior Professor, the School of Health and Society, the University of Wollongong, Australia

11-12 香港教育大學幼兒教育學系講座

Seminars by Department of Early Childhood Education, EdUHK

支持本地幼兒的情緒社交發展

Promoting local children's social-emotional development

Φ

鍾杰華教授 Prof. CHUNG Kevin Kien Hoa

林俊彬博士 Dr. LAM Chun Bun Ian

新冠肺炎與幼兒的心理健康

Covid-19 and children's mental health

Φ

黃敏博士 Dr. WONG Mun Amanda

E 英語主講 in English

Φ 粵語主講 in Cantonese

上午各場演講設中／英或英／中即時傳譯

Simultaneous interpretation (English to Chinese or vice versa) will be provided for the morning sessions.

下午 PM 分組研討

12:30 pm – 2:00 pm 海報匯報 Poster Presentations	2:00 pm – 4:10 pm 業界講座、工作坊及聊天室 Seminars, Workshops and Chat Rooms
--	---

各分組環節之發表題目及地點詳見第16-34頁。

Please refer to pp. 16 - 34 for the topics and venues of each session.



## 專題主講 Keynote Speech

在幼兒教育中推廣體育和運動技能的有效實證

**What Does the Evidence Say Works in terms of Promoting Physical Activity and Movement Skills in Early Childhood Education?** **E**

時間 Time: 9:45-10:45 地點 Venue: C-LP-11 and Zoom

**Prof. Anthony Okely**

Senior Professor, the School of Health and Society,  
The University of Wollongong, Australia

**E** 英語主講 in English

### 摘要 Abstract:

This presentation will focus on a number of contemporary issues important in understanding and promoting gross motor skill competence and physical activity in young children. It will draw on evidence, mostly from pre-school-aged children, to recommend how to develop fundamental movement skills in children. Identifying barriers to developing skills such as lack of space and equipment will be addressed, along with suggestions on how to develop a sequence of learning in early childhood settings. I will discuss how to set up environments in early childhood education settings to facilitate authentic assessment of fundamental movement skills. Finally, I will discuss how much physical activity children should participate in and the role of play-based learning to facilitate enjoyment, movement, and learning.





## 講者 Speaker:

Anthony Okely is a Senior Professor in the School of Health and Society at the University of Wollongong, Australia. He is a NHMRC Leadership Fellow (Level 2), and Theme Leader at the Illawarra Health & Medical Research Institute. He has been awarded over \$19 Million in competitive funding and published more than 300 peer-reviewed journal articles that have been cited more than 23,000 times. He has a h-index of 77.

His research focuses on movement behaviours (physical activity, sedentary behaviour, and sleep) in children, with a particular focus on low- and middle-income countries. He is the 6th most published researcher in the world on physical activity and children.

Prof. Okely led the team that developed the Australian 24-hr Movement Guidelines for Children birth to 5 years. He was part of the Guideline Development Group for the WHO guidelines on physical activity, sedentary and sleep behaviours in children under 5 years of age, and for similar guidelines in South Africa, Canada, the United Kingdom, and Asia-Pacific.

He currently leads an international study of movement behaviours in the early years called SUNRISE, which involves 41 countries, 25 of which are low - or middle-income.

In 2019 Prof. Okely was identified as a Highly Cited Researcher by Clarivate.

Anthony Okely教授為澳洲伍倫貢大學健康與社會學院資深教授，也是澳洲國家健康和醫學研究委員會(NHMRC)二級成員和伊拉瓦拉健康與醫學研究所負責人。他曾獲取超過一千九百萬元的競爭性資金和出版逾300篇同行評審期刊文章，其引用次數超過23,000次，h-index為77。

他的研究重點是兒童的運動行為（運動、久坐和睡眠），特別關注低收入和中等收入國家。在運動與兒童的領域，他的研究出版量位居全球第六。

Okely教授領導的團隊制定了澳洲兒童由出生至5歲期間的24小時運動指南。他是世界衛生組織關於5歲以下兒童運動、久坐和睡眠行為的全球指南以及南非、加拿大和英國的類似指南的指南制定小組的成員。

目前，他正領導一項名為SUNRISE的早年運動行為國際研究，該研究涉及41個國家，其中25個為中低收入國家。

科睿唯安(Clarivate)於2019年評定Okely教授為最高被引用研究員。



**Prof. Anthony Okely**  
Senior Professor, the School  
of Health and Society,  
The University of  
Wollongong, Australia

# 教大講座 EdUHK Seminars

香港教育大學幼兒教育學系講座

Seminars by Department of Early Childhood Education, The Education University of Hong Kong

時間 Time: 11:00-12:00 地點 Venue: C-LP-11 and Zoom

## 講座一 Seminar 1

支持本地幼兒的情緒社交發展

Promoting Local Children's Social-emotional Development



**Professor CHUNG Kevin Kien Hoa 鍾杰華教授**

Director, Centre for Child and Family Science; Chair Professor, Child Development and Special Education, The Education University of Hong Kong

香港教育大學兒童與家庭科學中心總監暨幼兒發展與特殊教育講座教授

**Dr. LAM Chun Bun Ian 林俊彬博士**

Co-Director, Centre for Child and Family Science; Associate Professor, The Education University of Hong Kong

香港教育大學兒童與家庭科學中心聯席總監暨副教授



粵語主講 in Cantonese

### 摘要 Abstract:

Research indicates that children's social-emotional competence has long-term implications for their academic and behavioral development, but most of this work has been based on Western data. In the presentation, the speakers will talk about how social-emotional competence is conceptualized in a Chinese context, and how it is linked to kindergarten-aged children's school readiness and behavioral adjustment. The speakers will also talk about how teachers may promote Chinese

children's social-emotional competence through one-on-one interactions or small-group activities. Concrete examples will be used to illustrate how social-emotional education can be conducted in the classroom.

研究發現，兒童的情緒社交能力對他們的學業和行為發展都有長遠的影響，但大部份研究都建基於西方數據。在這個演說中，講者會講述本地老師和家長如何定義幼兒的情緒社交能力，並講述情緒社交能力與入學準備和行為調適之間的關係。講者亦會分享老師如何可以通過一對一的互動或小組活動，支持本地幼兒的情緒社交發展。講者會使用實際可行的教學例子，解釋如何可以於學校中推行情緒社交教育。



## 講者 Speaker:

Professor Chung's research and teaching focus on dyslexia and learning disabilities, cognitive and social-emotional development, literacy acquisition, assessment and instruction. He has published extensively in journal articles and book chapters, and has produced learning and teaching products and software. He has also offered advice to government departments, NGOs and institutions both locally and internationally.

鍾教授的研究及教學範疇主要為學習困難、閱讀障礙、認知及社交情緒發展、讀寫學習、評估與教學。他曾在學術期刊及專書發表大量論文，並研發了多項教學產品和軟件。還時常為本地及國際的政府部門、非政府組織和教育機構提供建議。



鍾杰華教授

Prof. CHUNG Kevin Kien Hoa

## 講者 Speaker:

Dr Lam is an associate professor of Department of Early Childhood Education and a co-director of Centre for Child and Family Science in EdUHK. He has published more than 50 academic articles in international journals, with a focus on how family relationships may shape child development. Dr Lam has provided teacher training or parent education for more than 120 local schools. Also, he was elected the 2021-2023 President of the Committee on Early Childhood Education under Curriculum Development Council.

林博士是教大幼兒教育學系副教授及兒童與家庭科學中心聯席總監，研究家庭關係如何影響兒童發展，至今已在國際期刊發表超過50篇學術文章。林博士曾為超過120間本地學校舉行教師培訓或家長講座，並獲選為香港教育局課程發展處幼兒教育2021-2023年度委員會主席。



林俊彬博士

Dr. LAM Chun Bun Ian

### 講座三 Seminar 2

## 新冠肺炎與幼兒的心理健康

## Covid-19 and Children's Mental Health

**Dr. WONG Mun Amanda 黃敏博士**

Assistant Professor, The Education University of Hong Kong  
香港教育大學助理教授

 粵語主講 in Cantonese

### 摘要 Abstract:

This presentation focuses on issues related to mental health of children during Covid-19, including a preliminary study on preschool children's emotions and coping during the pandemic in the Hong Kong context. Recommendations for promoting young children's mental health will be discussed at the end of the presentation.

Two main questions:

1. What are the key mental health challenges for children during the coronavirus pandemic?
2. What might help young children to manage these challenges?

這個講座將會集中討論疫情期間幼兒的心理健康，當中包括一個香港幼兒在疫情期間處理情緒的初步研究。結尾部份也會為促進幼兒心理健康提出建議及討論。

兩個主要議題：

1. 在新冠肺炎影響下，幼兒的心理健康面對著甚麼挑戰？
2. 有甚麼方法可以應付這些挑戰？





### 講者 Speaker:

Dr. Amanda Wong's research interests lie in young children's social and emotional well-being, including how young children cope with stress associated with (1) death of the loved one, (2) bullying and academic achievement. Dr. Wong is the Project Leaders of different social and emotional learning programmes (SEL) – (1) Zippy's Friends, (2) the ECE Peace Ambassador (ECE-PAP) (GRF Project) and Life Education in Preschool (QEF project). More than 93,000 5-7-year-old children in Hong Kong have been benefited from the Zippy's Friends programme with significant improvement in expressing emotions, solving problems and learning attitude. The ECE-PAP promotes children's emotional intelligence skills and motivate children to reduce peer bullying. Life Education in Preschool Project helps children to understand their relationship with self, others and the environment.



黃敏博士  
Dr. WONG Mun Amanda

黃敏博士致力研究兒童的社交和情緒健康，包括兒童如何應對不同的壓力，包括兒童如何(1)面對致親的離世，(2)處理欺凌和學業成就相關的壓力。黃博士是多個社交和情緒發展研究項目的負責人——包括(1)比比和朋友計劃，(2)兒童和平大使計劃(ECE-PAP)(GRF Project)和幼稚園生命教育：抗逆小天使——兒童成長計劃(QEF project)。超過93,000名香港5-7歲兒童受益於比比和朋友計劃；參與計劃的兒童在表達情感、解決問題和學習態度方面都有顯著改善。ECE-PAP旨在促進兒童的情緒智力，激勵兒童主動減少同伴間的欺凌。幼稚園生命教育計劃幫助孩子們了解他們與自我、他人和環境的關係。



## 分組研討 Parallel Sessions

為了加強互動和實踐成效，研討會邀請教大師生及多間幼教機構作專題發表，與業界分享教研成果、教學方法和心得。

To enhance interactions and outcomes, the Conference has invited EdUHK academic staff and students, and representatives from early childhood education organizations, to share their research findings, teaching methods and experience with the industry.

---

### 12:30pm-2:00pm海報匯報Poster Presentations

本環節為時90分鐘，乃供幼教機構及教大同事和學生以電子海報形式，展示其教學計劃或教研成果。匯報者需以文字、圖像及短片綜述其專題之目的、實行方法、案例、成果和建議，並與參觀者交流意見。

The poster session provides kindergartens, organizations and EdUHK student/Staff opportunities to showcase their projects and activities, and engage in conversation with visitors on the spot. The 90-minute electronic poster presentation requires presenters to use both texts, images and videos to distill a teaching and learning or research project of the school or organization, including the objectives, approaches, case highlights, findings, review and recommendations.

地點 Venue: C-LP-02, Zoom

## 12:30pm-2:00pm海報匯報Poster Presentations

發表題目／發表者 Presentation Title / Presenter(s)

### Development of a Pediatric Quality of Life Pictorial Scale Protocol

Ms. Tang Chor Wai Tracy (PhD student)

The Education University of Hong Kong

### 內容摘要 Summary

Quality of life can be defined as an indicator of contentment in one's life. More specifically quality of life within children is an important indicator of overall health as it encompasses: mental, social, physical and functional health. Children who are healthy within these domains report lesser healthcare costs, family burden and parental stress. With this, quality of life is greatly supported as an indicator of overall well-being and as a predictor. Quality of life is an important indicator of well-being, but within a child sample, it is a hard concept to measure and usually measured via proxy (parents) or self-report methods. Although both methods have its respective strengths, studies that compared these results have found that they differ significantly. Moreover, qualitative interview studies that investigated such have found that parents tended to focus and remember their child's negative behaviour, such as throwing a tantrum, crying or yelling instead of the positive behaviours (i.e. tidying up after play). To this end, proxy report may not be necessarily accurate in capturing child QoL. Given this, current research only has questionnaires to measured child QoL in ages 4+ due to language and understanding ability. One way to overcome this is a pictorial scale. Pictorial scales are not new in the literature as these have already been developed in other contexts (i.e. personality, depression). However, there has not still been a pictorial QoL scale developed. This leads to my current project proposal of developing a pictorial scale, measuring children's QoL. In this project I will utilize a scale that has been previously validated and is widely used to measure children's quality of life at the age of 5, namely the pediatric quality of life scale, and develop pictorial corresponding items. This will then be scrutinized by experts and parents prior to pilot testing in children.

 英語主講 in English

## 12:30pm-2:00pm海報匯報Poster Presentations

發表題目／發表者 Presentation Title / Presenter(s)

### Prevention of Domestic Injury for Infants and Toddlers in Hong Kong

Ms. Chiu Man Ying (Research Assistant)  
The Education University of Hong Kong

#### 內容摘要 Summary

Unintentional domestic injury is a major cause of disabilities and premature deaths in young children. Existing injury surveillance data from the government only reflected injuries that required medical treatment from the hospitals or fatal injury incidence. In this study, we would like to conduct a survey about the prevalence of domestic injury among infants and toddlers (age 0 – 2 years old) in Hong Kong. Our survey was distributed to the parents and grandparents of 297 families with at least one child aged 0 – 2 years old. The data showed that 61% of children had experienced domestic accidents. Among those who had an accident, 52.5% of them had sustained injuries. Although most had light injuries (e.g., bumps or scratches), few suffered from more severe consequences (e.g. suffocation or burn). In this poster presentation, we will introduce the current situation of domestic injury in Hong Kong and present our preliminary data on common types of injuries sustained by young children at home.

 英語主講 in English

## 12:30pm-2:00pm海報匯報Poster Presentations

### 發表題目／發表者 Presentation Title / Presenter(s)

#### **Mothers' Perceived COVID-19 Stress and Child Adjustment: The Mediating Role of Mindful Parenting**

Ms. Wang Yili (Student from Master of Arts in Child and Family Education)

Dr. Rebecca Y. M. Cheung (Assistant Professor)

Ms. Xu Yu (Student from Master of Arts in Child and Family Education)

The Education University of Hong Kong

### 內容摘要 Summary

The present study investigated mindful parenting as a mediator between mother's perceived stress from the COVID-19 pandemic and child adjustment, including internalizing problems, externalizing problems, and prosocial behavior. Findings based on structural equation modeling indicated that mindful parenting, as indexed by mothers' emotional awareness of self and the child, emotional nonreactivity, listening with full attention, nonjudgmental acceptance, and compassion for the child, mediated between mothers' experience of COVID-19 stress and child adjustment,  $\chi^2(46) = 56.60$ ,  $p > .05$ , CFI = .97, TLI = .95, RMSEA = .04, SRMR = .06. These findings suggested that the stress experienced by mothers during the pandemic is relevant to both parenting behaviors and child adjustment.

 英語主講 in English

## 12:30pm-2:00pm海報匯報Poster Presentations

發表題目／發表者 Presentation Title / Presenter(s)

### Prioritizing Wellbeing for Young Learners

Mrs. Jess Gosling (Reception Teacher)  
Taipei European School

#### 內容摘要 Summary

In this online poster I would discuss how wellbeing is central to working with young, EAL children. The curriculum and pedagogy of an EAL classroom must prioritise the social, emotional and developmental needs of these learners. These considerations come prior to learning a second language, as they are paramount to creating a secure, safe environment built with trust.

I would show 5~10 key strategies to improve wellbeing, including focus on additional language plus native language acquisition.

\*This presentation is available on Zoom only.

 英語主講 in English

## 12:30pm-2:00pm海報匯報Poster Presentations

發表題目／發表者 Presentation Title / Presenter(s)

### Parenting During COVID-19: The Relationship between Perceived Stress and Parental Burnout

Dr. Jenny Lee Vaydich (Associate Professor of Psychology)

Seattle Pacific University

Dr. Rebecca Y. M. Cheung (Assistant Professor)

The Education University of Hong Kong

Ms. Berkley Barnum (Undergraduate Research Assistant)

Miss Anna Beery (Undergraduate Research Assistant)

Seattle Pacific University

### 內容摘要 Summary

Parenting can be stressful, and the COVID-19 pandemic introduces many new challenges, such as navigating changes in daily routines. These challenges contribute to parental stress and burnout (Aguilar et al., 2021), which can reduce parents' emotional responsiveness towards children (Roskam et al., 2018). However, parents also experience positive changes including improved coparenting (Giannotti et al., 2021). Hence, understanding the risk and protective factors on parental burnout is crucial during this period. One hundred fifty-five participants in the USA completed a survey assessing their parenting experiences during COVID-19. Multiple regression was conducted to explore parental stress, covid traumatic stress, and coparenting support as predictors of parental burnout. The model explained 61.2% of the variance, with parental stress and coparenting support significantly predicting burnout. Consistent with studies conducted prior to the pandemic (Roskam et al., 2017), findings suggest parental stress and coparenting support are crucial to parental burnout during COVID-19 in the USA. As such, direct support of coparenting may foster parents' well-being, particularly when they are experiencing heightened stress.

 英語主講 in English

## 2:00pm-4:10pm 業界講座 Seminars / 工作坊 Workshops / 聊天室 Chat Rooms

### 業界講座 Seminars

講者需在30分鐘內以PPT簡報形式作口頭發表，介紹機構如何透過不同策略和活動去改善及提升幼兒的心理和身體健康，使他們在愉快的環境下繼續學習，從而給予他們最大的幸福感。

The speakers will deliver a 30-minute presentation to demonstrate various strategies and school activities that help children explore freely in their environments, and to introduce initiatives that foster children's health and well-being.

### 工作坊 Workshops

工作坊每節45分鐘，旨在提供一互動場域，供發表者以不同模式（例如即場示範及試做、小組活動、與聽眾討論等）探討及整合與大會主題相關之議題。

Each workshop lasts for 45 minutes. It provides an interactive space with diversified formats like on-the spot demonstration or tryouts, group activities, debates, etc., for discussing and integrating issues related to the Conference theme.

### 聊天室 Chat Rooms

聊天室長40分鐘，它提供一個平台供教育學者與前線工作者直接交流意見和實戰經驗。大會設一個聊天室由資深學者主持。研討會參加者可按個人興趣和需要自由到場參與及提問、諮詢或分享經驗。

The Chat Room lasts for 40 minutes. It provides a chance for academics and practitioners to exchange ideas and experience.

One Chat Room will be hosted by experts in the Department of Early Childhood Education. Conference participants are free to drop at any time during the session.



## Room 1 – Venue (English and Chinese Sessions): B3-LP-08

房號1 – 地點（英文及中文環節）：B3-LP-08

### 時間 Time

2:00-2:30 (Seminar)

### 發表題目／發表者 Presentation Title / Presenter(s)

#### Wellbeing in the Curriculum – Is Motional Wellbeing Learnable and Teachable?

Mr. Jan Dubiel (Director of Early Years)

Ms. Tessa Ho (Early Year Developer)

AISL Harrow Schools

### 內容摘要 Summary

Ensuring the role of wellbeing occupies its appropriate role in the arena of curriculum ‘content’ is fraught with challenges and anomalies. These challenges are even more pronounced when this is then transferred into an assessment system to evaluate the impact of the Curriculum. Is it possible to appropriately teach and provide for the development of emotional Wellbeing and provide a pedagogical repertoire that facilitates it? Can we quantify and qualify the impact of such approaches? In this seminar we will discuss the development of the AISL Harrow Early Years Curriculum (AHEYC) which includes the aspect of ‘Emotional Development and Wellbeing’ as one of its five its ‘Learning Disciplines’. Encompassing Emotional Literacy, Empathy and Co/self-regulation, it is designed to provide a coherent structure to supporting and developing Kindergarten children’s experiences. It will explore the rationale and background to how this was developed and describe how this will be implemented within AISL Harrow International Schools and Bi-lingual Kindergartens.



粵語主講 in Cantonese



英語主講 in English

## Room 1 – Venue (English and Chinese Sessions): B3-LP-08

房號1 – 地點（英文及中文環節）：B3-LP-08

### 時間 Time

2:30-3:00 (Seminar)

### 發表題目／發表者 Presentation Title / Presenter(s)

## Household Crowdedness in Hong Kong and Its Impact on Parents' and Children's Wellbeing during COVID

Dr. Wang, Zhenlin (Assistant Professor)

The Education University of Hong Kong

### 內容摘要 Summary

During the COVID-19 pandemic, families worldwide are confined in their homes for an extended period of time due to social distancing. The current study examined the impact of household crowdedness during school closure on parents' COVID-related stress and young children's problem behaviors in a Hong Kong context, one of the world's most densely populated cities. Parents of 228 young children between 3- to 5-year-old reported their household living condition, parents' COVID-related stress, and children's problem behaviors through an online survey. Household crowdedness predicted parents' COVID-related stress, which in turn affected children's problem behaviors, controlling for family socioeconomic status. The study contributed to the growing research on the impact of the physical living environment as part of the ecological systems on family and child functioning. In time of crisis, young children rely on schools to support their development and wellbeing. The current findings caution the decision of school closure.

 英語主講 in English

## Room 1 – Venue (English and Chinese Sessions): B3-LP-08

房號1 – 地點（英文及中文環節）：B3-LP-08

### 時間 Time

3:10-3:40 (Seminar)

### 發表題目／發表者 Presentation Title / Presenter(s)

## Challenges Redefining the Early Childhood Education Sector in the Uncertain Normal

Ms. Julie Chu (Education Development and Operations Director)  
Maple Bear Canadian International Kindergarten

### 內容摘要 Summary

The global COVID-19 world health pandemic has profound implications for the education landscape of young children at homes and schools. Experts estimate that a whole year of learning could be lost, lagging behind in their learning, modifications to teaching for teachers and reliance on technology.

Leaders and teachers have not been given a choice and had to immediately create new learning environments, which foster student progress by adapting their existing teaching skills or lose their jobs. Online instruction has become a dominant learning and teaching format, which has been leading to the worldwide emergence of eLearning even for our young learners.

As the social distancing continues, what are some of the difficulties of face-to-face education? The sudden worry about classroom hygiene and sensitivity to any child with COVID symptoms. The affect is mainly on the two-year old's who have not learnt to step outside the house without masks and not seen facial expressions. The next challenge is yet to come when they have to live without masks and that will be a new norm for all our young learners.

We do appreciate the significant diversity within our community and families, and how we all face unique challenges regarding work commitments, internet access, mobilising resources for students, shared study spaces for children and lack of outdoor time, just to name a few. After reflecting on the past two years' we highly appreciate the power of positive parenting' and the vital role we all play as advocates and educators. We will also look at some insightful solutions we took at our kindergarten for better student engagement and quality learning during these challenging times.

## Room 1 – Venue (English and Chinese Sessions): B3-LP-08

房號1 – 地點（英文及中文環節）：B3-LP-08

### 時間 Time

Chat Room 3:40-4:20

### 發表題目／發表者 Presentation Title / Presenter(s)

#### Session for Doctor of Education (Specialized Area in Early Childhood Education)

Dr. Tam Po Chi Pansy (Assistant Professor)

The Education University of Hong Kong

### 內容摘要 Summary

This chatroom welcomes anyone who is interested to pursue doctoral study in our department. We will mainly introduce our EdD programme which aims at professional practitioners in early childhood education who are committed to extending their understanding and improving practice. For example, in the current cohorts there are school leaders, teachers, early childhood educators and also university lecturers. Apart from introducing the programme structure, we will also invite graduate to share their learning experiences to the participants.

 英語主講 in English

## Room 2 – Venue (Chinese Sessions): B3-LP-05 房號2 – 地點（中文環節）：B3-LP-05

### 時間 Time

2:00-2:30（業界講座）

### 發表題目／發表者 Presentation Title / Presenter(s)

#### 如何建立幼兒情緒智力和技能

何彩華博士（教育及研究學者）

### 內容摘要 Summary

根據香港救助兒童會的調查報告，接近40%中小學生有不同程度的精神健康問題；零至八歲是兒童性格形成的重要階段，讓幼兒學習如何識別和管理自身情緒，並建設性地處理具有挑戰性的情況，是精神健康的基礎。本講座的主旨是如何建立幼兒情緒智力和技能，透過美國教育專家Ellen Dodge設計的Kimochis®情緒感覺公仔教材，讓老師們認識實用和有趣的方法，教導孩子掌握情緒和社交技能，幫助保持精神健康。

 粵語主講 in Cantonese

## Room 2 – Venue (Chinese Sessions): B3-LP-05 房號2 – 地點（中文環節）：B3-LP-05

### 時間 Time

2:30-3:00（業界講座）

### 發表題目／發表者 Presentation Title / Presenter(s)

#### 體適能對幼兒發展的正面影響及成人／照顧者的角色

基督教樂道幼稚園  
何敏茵女士（校長）

### 內容摘要 Summary

相信大家都會有多做運動對身體有益的概念，而不少的研究都指出適量的體能活動，對幼兒不同方面的發展都有着正面的影響，但到底這些活動如何正面地幫助幼兒發展？

而當大家都知道體能活動對幼兒的好處，為何社會上的幼兒，還是有運動不足或是有肥胖的問題存在？

在分享中會淺談體能活動如何幫助幼兒各方面的發展，以及如何在幼稚園推廣體能活動，讓幼兒不論在校園或是在家，都有更多活動筋骨的機會。

 粵語主講 in Cantonese

## Room 2 – Venue (Chinese Sessions): B3-LP-05 房號2 – 地點（中文環節）：B3-LP-05

### 時間 Time

3:10-3:40（業界講座）

### 發表題目／發表者 Presentation Title / Presenter(s)

#### 全港首創的幼兒醫學課程

香港西區婦女福利會幼稚園  
溫志倫先生（校長）  
萬德加先生（高級教育顧問）

### 內容摘要 Summary

課程重視學生的生命和衛生意識，讓他們會學習初步急救的方法，以助人自助和救急扶危為目的。同時，亦會重視防疫方法，讓學生透過體驗式教學，明白醫生之所以能救人，除了技術之外，更重要的就是要有仁心。不管貧窮富貴，都要一視同仁。醫德仁心的重要性，建立良好的價值觀，培育他們成為醫護專業的未來人才。小朋友亦能透過人體器官模型，瞭解不同器官的構造和用途，進一步瞭解生命的價值和意義，並懂得保護自己及尊重別人的身體。

 粵語主講 in Cantonese



## Room 2 – Venue (Chinese Sessions): B3-LP-05 房號2 – 地點（中文環節）：B3-LP-05

### 時間 Time

3:40-4:10（工作坊）

### 發表題目／發表者 Presentation Title / Presenter(s)

#### 學前幼童健康飲食之「是與非」

香港教育大學  
尹詠霖女士（博士生）

### 內容摘要 Summary

這個工作坊將分成兩部分。在第一部分，我會分享一些有助學前幼童培養健康飲食習慣的小貼示，例如如何選擇健康的早餐，以及了解幼童健康飲食金字塔和營養飲食建議。此外，我會拆解以下常見的幼童營養迷思，包括：

1. 喝果汁能代替吃蔬菜嗎？
2. 人工甜味劑會損害幼童健康嗎？
3. 一般幼童需要額外的營養補充品嗎？
4. 全脂牛奶是幼童飲食的好選擇嗎？
5. 植物牛奶比全脂牛奶更適合幼童嗎？

在第二部分，我會舉辦一場工作坊讓家長和學前教師學習如何閱讀預先包裝食物上的營養標籤。市面上的預先包裝食品普遍會展示其營養資訊或成分表，但家長和學前教師通常很困難地辨別出健康食品，以及哪些資訊對保持學前幼童的均衡飲食最為重要。透過本次工作坊，觀眾將能更解讀食品上列出的營養標籤，了解各類食物的營養價值，比較不同食物的營養成分，從而為學前兒童的飲食作出較健康的選擇。另外，他們也能明白學前幼童的飲食中應包含哪些食物種類以及每日建議分量。

 粵語主講 in Cantonese

## Room 3 – Venue (Chinese Sessions): B3-LP-06 房號3 – 地點（中文環節）：B3-LP-06

### 時間 Time

2:00-2:30（業界講座）

### 發表題目／發表者 Presentation Title / Presenter(s)

**在香港幼兒園推廣運動指南：甚麼指南？為什麼？如何推行？** 

香港教育大學

陳愛玲女士（客席講師）

### 內容摘要 Summary

幼兒時期的運動健康行為可以為未來成年階段帶來對身心不同的益處。於2019年，世界衛生組織(WHO)推出了《五歲以下兒童身體活動、久坐行為及睡眠指引》，並於2020年由香港衛生防護中心(CHP)採納。該指引適用於2-6歲的幼兒。是次的研究項目是由醫療衛生研究基金(HMRF)資助的，透過為本地各區幼稚園的教師和家長們舉辦講座和工作坊，來宣揚有關此指引的訊息。在是次研討會中，我們將會介紹一些與幼兒運動，屏幕時間和睡眠時間的相關指南。我們亦會介紹兒童需要充足體育活動和優質睡眠的原因。最後，我們將會分享一些幼兒園教師在課堂上加強體育元素的途徑與技巧。

 粵語主講 in Cantonese

## Room 3 – Venue (Chinese Sessions): B3-LP-06 房號3 – 地點（中文環節）：B3-LP-06

### 時間 Time

2:30-3:00（業界講座）

### 發表題目／發表者 Presentation Title / Presenter(s)

**有品孩子好健康、好幸福** 中

禮賢會學校  
關淑玲女士（校長）

### 內容摘要 Summary

自2014年起，本校便推行「有品校園」計劃，每年以四個範疇來培養兒童的品格，即使去年受疫情影響，延遲開課及有數個月未能全面恢復面授課堂，學校仍堅持以三個範疇及調節箇中活動模式，期望孩子在家進行非面授課堂時，仍能與爸媽參與親子品德活動，及以家校合作模式，發揮品德教育功能，產生相輔相成的成效。本人堅信自小培養兒童有良好品德，在成長過程中，必有理想的健康質素及美滿的幸福感。

中 粵語主講 in Cantonese

## Room 3 – Venue (Chinese Sessions): B3-LP-06 房號3 – 地點（中文環節）：B3-LP-06

### 時間 Time

3:10-3:40（業界講座）

### 發表題目／發表者 Presentation Title / Presenter(s)

#### 自主潛能伴成長 正面生活添幸福

香港基督教服務處李鄭屋幼兒學校  
蘇媛媛女士（校長）  
藍嘉怡女士（主任）  
張家穎女士（幼兒教師）

### 內容摘要 Summary

幼兒天生富有好奇心，對喜歡的事物會自發及更有動力去完成。學校透過蒙特梭利的教學法，預備了一些日常生活的工作，例如：拖地、抹桌、刨皮切粒、榨汁、處理蔬菜等。讓幼兒從中學習，累積成功感，從而懂得欣賞自己、欣賞他人，建立幸福感。

 粵語主講 in Cantonese

## Room 3 – Venue (Chinese Sessions): B3-LP-06 房號3 – 地點（中文環節）：B3-LP-06

### 時間 Time

3:40-4:10（業界講座）

### 發表題目／發表者 Presentation Title / Presenter(s)

#### 幼兒STEM課程

聖公會聖三一堂曾肇添幼稚園

鄭曼淇女士（主任）

徐建齡女士（老師）

梅慧敏女士（老師）

### 內容摘要 Summary

本園於2019年獲香港專業教育學院(IVE)參與幼兒STEM先導計劃，並於2020年再度獲邀參與賽馬會「智·幼·趣」計劃（下稱計劃）伙伴學校，為期三年的前瞻性研究，計劃探索本港幼兒STEM教育之發展方向，開發適合香港的STEM教學模式。

本園的教學理念與計劃的一致，幼兒從生活中學習，從生活中發現問題，激發幼兒的學習興趣與動力，老師透過計劃安排的教師培訓及工作坊學習，嘗試應用工程設計的流程帶動幼兒STEM教學，藉著教學實踐，培養幼兒科學精神，啟發幼兒的創意、好奇心和探索動機，促進幼兒解難思維的能力，以多元方法解決生活中的問題。

本園對幼兒STEM作教學初探，從中獲得寶貴的經驗，藉這次的交流機會，更期望得著幼教同行者的回饋，增強我們對幼兒STEM的教學更鞏固和信心，為幼兒謀福祉，謝謝！

 粵語主講 in Cantonese

# 鳴謝：伙伴學校

## Vote of Thanks: School Partners



### EdUHK ECE-School Partnership Programme

香港教育大學幼兒教育學系於2016年啟動「學校合作伙伴計劃」，表揚為本校的幼兒教育課程提供教學實習機會和協助的幼稚園及幼兒園。下列各校於過去三年皆為我們的實習伙伴，本學系特頒感謝狀以申謝忱，並冀日後能延續此合作關係，為本地教育的承傳共同努力，作出更多貢獻。如有興趣加入我們，歡迎與我們聯絡。

The Department of Early Childhood Education (ECE) at EdUHK launched the “**EdUHK ECE-School Partnership Programme**” in 2016, to recognize the contribution of local kindergartens / preschools which offer practicum opportunities and support to its teacher education programmes. The following schools have been our field experience partners for 3 consecutive years. As a token of appreciation, certificates will be presented and we look forward to long term collaboration with our school partners, leading the local educational field to move to a higher level of excellence. Please contact us if you are interested in joining the programme.

#### 伙伴學校名錄 List of School Partners (按中文校名筆劃序 by Chinese school name)

九龍城浸信會禧年幼稚園	KOWLOON CITY BAPTIST CHURCH HAY NIEN KINDERGARTEN
上水惠州幼稚園（分校）	SHEUNG SHUI WAI CHOW KINDERGARTEN (BRANCH)
大埔浸信會幼稚園運頭塘邨分校	TAI PO BAPTIST KINDERGARTEN WAN TAU TONG ESTATE BRANCH
大埔循道衛理幼稚園	TAI PO METHODIST KINDERGARTEN

大埔禮賢會幼稚園	TAI PO RHENISH CHURCH KINDERGARTEN
小牛頓中英文幼稚園	LITTLE NEWTON ANGLO-CHINESE KINDERGARTEN
中國基督教播道會天恩幼兒學校	EVANGELICAL FREE CHURCH OF CHINA - TIN YAN NURSERY SCHOOL
中華基督教青年會葵涌幼稚園	CHINESE YMCA KWAI CHUNG KINDERGARTEN
中華基督教會上水堂幼稚園	SHEUNG SHUI CHURCH KINDERGARTEN
中華基督教會屯門堂何福堂幼稚園	HOH FUK TONG KINDERGARTEN (TUEN MUN CHURCH, THE CHURCH OF CHRIST IN CHINA, HONG KONG COUNCIL)
中華基督教會沙田堂博康幼稚園	THE CHURCH OF CHRIST IN CHINA, SHATIN CHURCH POK HONG KINDERGARTEN
中華基督教會基法幼稚園	THE CHURCH OF CHRIST IN CHINA KEI FAAT KINDERGARTEN
中華基督教會基真幼稚園	THE CHURCH OF CHRIST IN CHINA KEI CHUN KINDERGARTEN
中華基督教會基華幼稚園	THE CHURCH OF CHRIST IN CHINA KEI WA KINDERGARTEN
中華基督教會福幼幼稚園	THE CHURCH OF CHRIST IN CHINA FUK YAU KINDERGARTEN
中華基督教會福幼第二幼稚園	THE CHURCH OF CHRIST IN CHINA FUK YAU NO. II KINDERGARTEN

中華傳道會基石幼稚園	CNEC CHRISTIAN KINDERGARTEN
仁濟醫院永隆幼稚園	YAN CHAI HOSPITAL WING LUNG KINDERGARTEN
仁濟醫院明德幼稚園	YAN CHAI HOSPITAL MING TAK KINDERGARTEN
仁濟醫院林李婉冰幼稚園	YAN CHAI HOSPITAL NINA LAM KINDERGARTEN
仁濟醫院董伯英幼稚園	YAN CHAI HOSPITAL TUNG PAK YING KINDERGARTEN
元朗商會幼稚園	YUEN LONG MERCHANTS ASSOCIATION KINDERGARTEN
天水圍宣道幼稚園	TIN SHUI WAI ALLIANCE KINDERGARTEN
天主教聖瑪加利大幼稚園	ST. MARGARET MARY'S CATHOLIC KINDERGARTEN
世佛會文殊幼兒學校	W.F.B. MANJUSRI NURSERY SCHOOL
世界龍岡學校朱瑞蘭（中英文）幼稚園	LUNG KONG WORLD FEDERATION SCHOOL LIMITED CHU SUI LAN ANGLO-CHINESE KINDERGARTEN
地利亞英文小學暨幼稚園	DELIA ENGLISH PRIMARY SCHOOL & KINDERGARTEN
竹園區神召會梁省德中英文幼稚園	PENTECOSTAL CHURCH OF HONG KONG LEUNG SING TAK ANGLO-CHINESE KINDERGARTEN
西太平洋幼稚園	WESTERN PACIFIC KINDERGARTEN



佛教金麗幼稚園	BUDDHIST KAM LAI KINDERGARTEN
佛教真如幼稚園（東涌）	BUDDHIST CHUN YUE KINDERGARTEN (TUNG CHUNG)
佛教慈光幼稚園	BUDDHIST CHI KWONG KINDERGARTEN
宏福中英文幼稚園	TIVOLI ANGLO-CHINESE KINDERGARTEN
宏福幼稚園	TIVOLI KINDERGARTEN
佳寶幼稚園	GUIDEPOSTS KINDERGARTEN
佳寶幼稚園（屯門分校）	GUIDEPOSTS KINDERGARTEN (TUEN MUN BRANCH)
佳寶幼稚園第三分校（天瑞邨）	GUIDEPOSTS KINDERGARTEN 3RD BRANCH (TIN SHUI ESTATE)
協康會天平中心	Heep Hong Society Tin Ping Centre
坪石英皇幼稚園	PING SHEK KINGSLAND KINDERGARTEN
明我幼稚園	DOMINIC SAVIO KINDERGARTEN
明我幼稚園（奧運校）	DOMINIC SAVIO KINDERGARTEN (OLYMPIC BRANCH)
明雅中英文幼稚園	MINK ANGLO-CHINESE KINDERGARTEN

東華三院九龍崇德社幼兒園	TWGHs ZONTA CLUB OF KOWLOON NURSERY SCHOOL
東華三院力勤幼稚園	TUNG WAH GROUP OF HOSPITALS NICKON KINDERGARTEN
東華三院方樹福堂幼稚園	TUNG WAH GROUP OF HOSPITALS FONG SHU FOOK TONG KINDERGARTEN
東華三院何藍瓊纓幼稚園	TWGHs LUCINA LAAM HO KINDERGARTEN
東華三院呂馮鳳紀念幼稚園	TWGHs LUI FUNG FAUNG MEMORIAL KINDERGARTEN
東華三院李黃慶祥紀念幼稚園	TWGHs LEE WONG HING-CHEUNG MEMORIAL KINDERGARTEN
東華三院洪王家琪幼兒園	TWGHs HUNG WONG KAR GEE NURSERY SCHOOL
東華三院香港華都獅子會幼稚園	TWGHs LIONS CLUB OF METROPOLITAN HONG KONG KINDERGARTEN
東華三院高德根紀念幼稚園	T.W.G.HS. KO TECK KIN MEMORIAL KINDERGARTEN
東華三院黃朱惠芬幼稚園	TUNG WAH GROUP OF HOSPITALS WONG CHU WAI FUN KINDERGARTEN
東華三院廖恩德紀念幼稚園	TUNG WAH GROUP OF HOSPITALS LIU YAN TAK MEMORIAL KINDERGARTEN
東華三院黎鄧潤球幼稚園	TUNG WAH GROUP OF HOSPITALS LAI TANG YUEN-KAW KINDERGARTEN

金巴崙長老會青草地幼稚園	CUMBERLAND PRESBYTERIAN CHURCH GREEN PASTURE KINDERGARTEN
青松興東幼稚園	CHING CHUNG HING TUNG KINDERGARTEN
保良局方王錦全幼稚園	PO LEUNG KUK MRS FONG WONG KAM CHUEN KINDERGARTEN
保良局田家炳兆康幼稚園	PO LEUNG KUK TIN KA PING SIU HONG KINDERGARTEN
保良局吳多泰幼稚園	PO LEUNG KUK NG TOR TAI KINDERGARTEN
保良局李徐松聲紀念幼稚園	PO LEUNG KUK LI TSUI CHUNG SING MEMORIAL KINDERGARTEN
保良局易澤峯幼稚園	PO LEUNG KUK YICK CHARK FUNG KINDERGARTEN
保良局曹金霖夫人幼稚園	PO LEUNG KUK MRS. CHAO KING LIN KINDERGARTEN
保良局莊啓程幼稚園	PO LEUNG KUK VICWOOD CHONG KEE TING KINDERGARTEN
保良局曾星如幼稚園	PO LEUNG KUK CHAN SENG YEE KINDERGARTEN
保良局馮梁結紀念幼稚園	PO LEUNG KUK FUNG LEUNG KIT MEMORIAL KINDERGARTEN
保良局劉陳小寶幼稚園	PO LEUNG KUK LAU CHAN SIU PO KINDERGARTEN

保良局蔡冠深幼稚園	PO LEUNG KUK CHOI KOON SHUM KINDERGARTEN
宣道會秀茂坪陳李詠貞幼稚園	CHRISTIAN ALLIANCE SAU MAU PING CHEN LEE WING TSING KINDERGARTEN
宣道會雷蔡群樂幼稚園	CHRISTIAN ALLIANCE LOUEY CHOY KWAN LOK KINDERGARTEN
建生浸信會白普理幼兒園	KIN SANG BAPTIST CHURCH BRADBURY PRE-SCHOOL
珈琳中英文幼稚園	KARLAM ANGLO-CHINESE KINDERGARTEN
珈琳中英文幼稚園（龍門居分校）	KARLAM ANGLO-CHINESE KINDERGARTEN (OASIS GARDEN)
珈琳幼稚園（屯門分校）	KARLAM KINDERGARTEN (TUEN MUN BRANCH)
美雅幼兒園	MAY NGA NURSERY
美雅幼稚園	MAY NGA KINDERGARTEN
美雅幼稚園（分校）	MAY NGA KINDERGARTEN (BRANCH)
英揚樂兒中英文幼稚園	ELITE KIDS ANGLO-CHINESE KINDERGARTEN
香海正覺蓮社佛教慧光幼稚園	HHCKLA BUDDHIST WAI KWONG KINDERGARTEN

香港中文大學校友會聯會張煊昌幼稚園	CUHK FEDERATION OF ALUMNI ASSOCIATIONS THOMAS CHEUNG KINDERGARTEN
香港東區婦女福利會黎桂添幼兒園	WOMEN'S WELFARE CLUB (EASTERN DISTRICT) HONG KONG LAI KWAI TIM DAY NURSERY
香港保護兒童會胡好幼兒學校	HKSPC AW HOE NURSERY SCHOOL
香港宣教會優質幼兒學校	HKEC ELITE KINDERGARTEN
香港浸信會聯會香港西北扶輪社幼稚園	THE BAPTIST CONVENTION OF HONG KONG ROTARY CLUB OF HONG KONG NORTHWEST KINDERGARTEN
香港基督教女青年會宏恩幼稚園	HONG KONG Y.W.C.A ATHENA KINDERGARTEN
香港基督教女青年會趙靄華幼兒學校	HONG KONG YOUNG WOMEN'S CHRISTIAN ASSOCIATION CHIU OI WAH NURSERY SCHOOL
香港教育大學幼兒發展中心（幼稚園部）	THE EDUCATION UNIVERSITY OF HONG KONG EARLY CHILDHOOD LEARNING CENTRE(KINDERGARTEN SECTION)
香港創價幼稚園	HONG KONG SOKA KINDERGARTEN
香港聖公會青山聖彼得堂青雲路幼稚園	HKSKH ST PETER'S CHURCH CASTLE PEAK TSING WUN ROAD KINDERGARTEN
香港聖公會麥理浩夫人中心幼稚園	HONG KONG SHENG KUNG HUI LADY MACLEHOSE CENTRE KINDERGARTEN

香港道教聯合會圓玄幼稚園	HONG KONG TAOIST ASSOCIATION YUEN YUEN KINDERGARTEN
香港道教聯合會圓玄幼稚園（東頭邨）	HONG KONG TAOIST ASSOCIATION YUEN YUEN KINDERGARTEN (TUNG TAU ESTATE)
香港道教聯合會圓玄幼稚園（富善邨）	HONG KONG TAOIST ASSOCIATION YUEN YUEN KINDERGARTEN (FU SHIN ESTATE)
浸信會培理學校	BAPTIST PUI LI SCHOOL
浸信會華恩幼稚園	BAPTIST CHURCH SHINING GRACE KINDERGARTEN
浸信會愛羣社會服務處培殷幼兒學校	BAPTIST OI KWAN SOCIAL SERVICE PUI YAN PRE-PRIMARY SCHOOL
真理浸信會恩典幼稚園	TRUTH BAPTIST CHURCH GRACE KINDERGARTEN
神召會華人同工聯會彩蒲幼稚園	CHINESE CHRISTIAN WORKER'S FELLOWSHIP LTD. CHOI PO KINDERGARTEN
神召會禮拜堂天澤幼兒園	FIRST ASSEMBLY OF GOD CHURCH TIN CHAK NURSERY
荃浸石籬幼稚園	TSUEN WAN BAPTIST CHURCH SHEK LEI KINDERGARTEN
荃灣商會邱健峰幼稚園	TSUEN WAN TRADE ASSOCIATION YAU KIN FUNG KINDERGARTEN
高主教書院幼稚園部	RAIMONDI COLLEGE KINDERGARTEN SECTION

偉思幼稚園

WISELY KINDERGARTEN

基督教中國佈道會恩恩創意幼稚園

EVANGELIZE CHINA FELLOWSHIP BLESSINGS CREATIVITY KINDERGARTEN

基督教佈道中心樂富幼稚園

CHRISTIAN EVANGELICAL CENTRE LOK FU KINDERGARTEN

基督教宣道會天頌幼兒學校

CHRISTIAN & MISSIONARY ALLIANCE TIN CHUNG NURSERY SCHOOL

基督教宣道會沙田幼兒學校

CHRISTIAN & MISSIONARY ALLIANCE SHATIN NURSERY SCHOOL

基督教宣道會茵怡幼稚園

CHRISTIAN AND MISSIONARY ALLIANCE CHURCH VERBENA KINDERGARTEN

基督教宣道會寶湖幼兒學校

CHRISTIAN & MISSIONARY ALLIANCE PLOVER COVE NURSERY SCHOOL

基督教香港崇真會安怡幼兒學校

TSUNG TSIN MISSION OF HONG KONG ON YEE NURSERY SCHOOL

基督教香港崇真會安康幼兒學校（順寧道）

TSUNG TSIN MISSION OF HONG KONG ON HONG NURSERY SCHOOL (SHUN NING ROAD)

基督教香港崇真會安強幼兒學校

TSUNG TSIN MISSION OF HONG KONG ON KEUNG NURSERY SCHOOL

基督教聖約教會司務道幼稚園

THE MISSION COVENANT CHURCH SISTER ANNIE'S KINDERGARTEN



康盈中英文幼稚園	HONG YING ANGLO-CHINESE KINDERGARTEN
救世軍天平幼兒學校	THE SALVATION ARMY TIN PING NURSERY SCHOOL
救世軍吳國偉紀念幼稚園	THE SALVATION ARMY NG KWOK WAI MEMORIAL KINDERGARTEN
救世軍陳昆棟幼稚園	THE SALVATION ARMY CHAN KWAN TUNG KINDERGARTEN
救世軍富強幼稚園	THE SALVATION ARMY FU KEUNG KINDERGARTEN
救世軍錦田幼兒學校	THE SALVATION ARMY KAM TIN NURSERY SCHOOL
博愛醫院陳徐鳳蘭幼稚園	POK OI HOSPITAL CHAN HSU FONG LAM KINDERGARTEN
善一堂安逸幼稚園	SHIN YAT TONG ON YAT KINDERGARTEN
善一堂逸東幼稚園	SHIN YAT TONG YAT TUNG KINDERGARTEN
晶晶幼稚園（屯門校）	JING JING KINDERGARTEN (TUEN MUN BRANCH)
萌兒幼稚園	MOE KINDERGARTEN
雅士圖國際幼稚園	ARISTLE INTERNATIONAL KINDERGARTEN
雅麗斯樂思幼稚園	AGNES WISE KINDERGARTEN

順德聯誼總會梁李秀娛沙田幼稚園	SHUN TAK FRATERNAL ASSOCIATION LEUNG LEE SAU YU (SHATIN) KINDERGARTEN
嗇色園主辦可瑞幼稚園	HO SHUI KINDERGARTEN SPONSORED BY SIK SIK YUEN
圓玄幼稚園（平田邨）	YUEN YUEN KINDERGARTEN (PING TIN ESTATE)
愛群道浸信會呂郭碧鳳幼稚園	OI KWAN ROAD BAPTIST CHURCH LUI KWOK PAT FONG KINDERGARTEN
慈光幼稚園	BENEVOLENT LIGHT KINDERGARTEN
新界婦孺福利會長發邨幼兒學校	NTW&JWA LIMITED CHEUNG FAT ESTATE NURSERY SCHOOL
新界婦孺福利會粉嶺幼兒學校	NTW&JWA LIMITED FANLING NURSERY SCHOOL
新界婦孺福利會博康邨幼兒學校	NTW&JWA LIMITED POK HONG ESTATE NURSERY SCHOOL
粵南信義會腓力堂馬頭圍幼兒學園	LUTHERAN PHILIP HOUSE MA TAU WAI NURSERY SCHOOL
聖三一中心幼稚園	HOLY TRINITY CENTRE KINDERGARTEN
聖公會主誕堂幼稚園	SHENG KUNG HUI HOLY NATIVITY CHURCH KINDERGARTEN
聖公會青山聖彼得堂幼稚園	S.K.H. ST. PETER'S CHURCH KINDERGARTEN (CASTLE PEAK)

聖公會青山聖彼得堂兆麟苑幼稚園

S.K.H. ST. PETER'S CHURCH CASTLE PEAK SIU LUN COURT KINDERGARTEN

聖公會荊冕堂士德幼稚園

S.K.H. CROWN OF THORNS CHURCH SADICK KINDERGARTEN

聖公會救主堂幼稚園

SHENG KUNG HUI THE CHURCH OF OUR SAVIOUR KINDERGARTEN

聖公會慈光堂柯佩璋幼稚園

S.K.H. KINDLY LIGHT CHURCH OR PUI CHEUNG KINDERGARTEN

聖公會慈光堂聖匠幼稚園

S.K.H. KINDLY LIGHT CHURCH HOLY CARPENTER KINDERGARTEN

聖公會慈光堂聖匠幼稚園（分校）

S.K.H. KINDLY LIGHT CHURCH HOLY CARPENTER KINDERGARTEN (BRANCH)

聖公會靈風堂幼稚園

S.K.H. HOLY SPIRIT CHURCH KINDERGARTEN

聖文嘉中英文幼稚園

ST. MONICA'S ANGLO-CHINESE KINDERGARTEN

聖文嘉幼稚園

ST. MONICA'S KINDERGARTEN

聖多馬堂幼稚園

ST. THOMAS' CHURCH KINDERGARTEN

聖安多尼中英文小學暨幼稚園

ST ANTHONY'S ANGLO-CHINESE PRIMARY SCHOOL & KINDERGARTEN

聖安當幼稚園

ST. ANTONIUS KINDERGARTEN

聖馬提亞堂肖珍幼稚園

ST. MATTHIAS' CHURCH CHIU CHUN KINDERGARTEN

聖雅各福群會麥潔蓮幼稚園

ST JAMES' SETTLEMENT KATHLEEN MCDOUALL  
KINDERGARTEN

路德會救恩幼稚園

REDEMPTION LUTHERAN KINDERGARTEN

路德會陳蒙恩幼稚園

CHAN MUNG YAN LUTHERAN KINDERGARTEN

路德會愛心幼稚園

LOVING HEART LUTHERAN KINDERGARTEN

嘉福浸信會幼兒園

KA FUK BAPTIST CHURCH PRE-SCHOOL

滿樂幼稚園

MOON LOK KINDERGARTEN

維多利亞（何文田）國際幼兒園

VICTORIA (HOMANTIN) INTERNATIONAL NURSERY

維多利亞（海怡）國際幼稚園

VICTORIA (SOUTH HORIZONS) INTERNATIONAL  
KINDERGARTEN

翠林邨浸信會幼稚園

TSUI LAM ESTATE BAPTIST KINDERGARTEN

樂沛兒幼稚園

HONG KONG NOBEL PRESCHOOL

樂善堂張葉茂清幼稚園

LOK SIN TONG CHEUNG YIP MOU CHING KINDERGARTEN

樂善堂顧李覺鮮幼稚園

LOK SIN TONG KU LEE KWOK SIN KINDERGARTEN

蔚思幼稚園	SOPHIE KINDERGARTEN
學之園幼稚園	LEARNING HABITAT KINDERGARTEN
學之園幼稚園（海翩康城）	LEARNING HABITAT KINDERGARTEN (PAPILLONS LP)
翰林幼稚園（天水圍）	ACADEMY KINDERGARTEN (TIN SHUI WAI)
遵道幼稚園	ABIDING KINDERGARTEN
駿發花園浸信會幼兒學校	PROSPEROUS GARDEN BAPTIST NURSERY SCHOOL
藍田靈糧幼稚園	LAM TIN LING LIANG KINDERGARTEN
鯉魚門循道衛理幼稚園	LEI YUE MUN METHODIST KINDERGARTEN
懷恩浸信會幼稚園	GRACE BAPTIST KINDERGARTEN
麗晶幼稚園分校	REGENT'S KINDERGARTEN (BRANCH SCHOOL)
寶兒中英文幼稚園	BOWIE ANGLO-CHINESE KINDERGARTEN
耀東浸信會幼稚園	YIU TUNG BAPTIST KINDERGARTEN
耀基創藝幼稚園	GLORIA CREATIVE KINDERGARTEN
耀基創藝幼稚園（上水）	GLORIA CREATIVE KINDERGARTEN (SHEUNG SHUI)

# 附錄 Appendix

## 香港教育大學校園地圖 EDUHK Campus Map

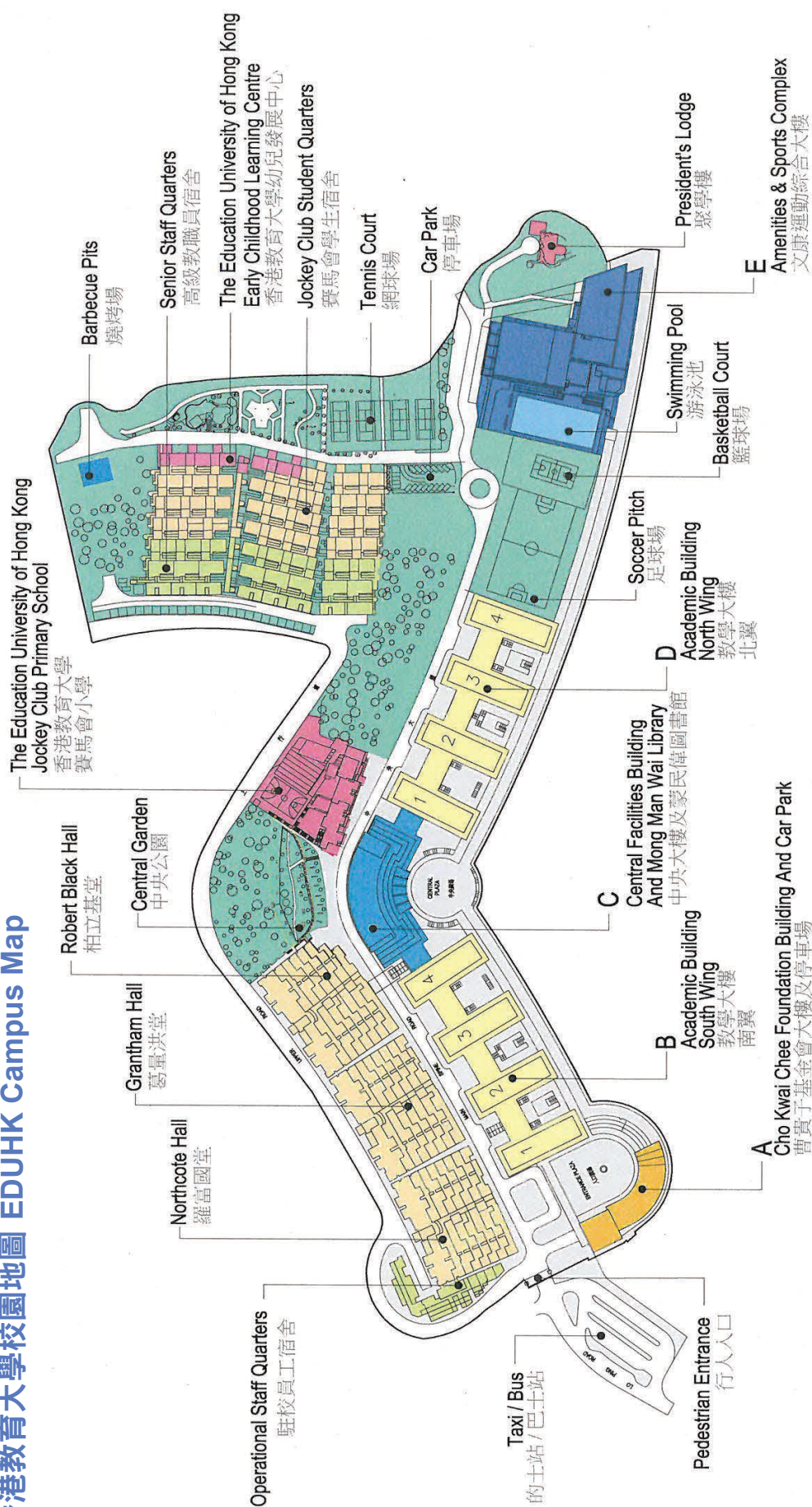

此乃空白頁  
This page is blank



# 追蹤我們的社交平台

## Follow us on social media



eduhk.ece



eduhk.ece



Early Childhood Education Department (EdUHK)



教大幼教



Department of Early Childhood Education EdUHK



[www.eduhk.hk/ece](http://www.eduhk.hk/ece)  
[ece@eduhk.hk](mailto:ece@eduhk.hk)  
(852) 2948 7762 / (852) 2948 7117